



# CENTRIFUGAL & PERIPHERAL PUMPS - 50Hz



#### Algo Profile

Algo positions itself as not just a pump manufacturing company but as a dependable, technologically sound and one stop solution provider to meet the diverse needs of customers across the globe. Understanding the need of efficient and cost effective pumping solutions and fluid management systems ALGO is established by the veterans having more than 30 years of diversified experience.

To overcome the current challenges in providing energy efficient and complete pumping solutions and meet the requirement of discerning customers ALGO is determined to offer technologically integrated and inventive pumping systems & Solutions at affordable prices.

With the vast experience gained in both domestic and international markets ALGO products are designed and produced with synergy of best in class technologies and processes with international standards. Most of its products are ISI certified and manufacturing facilities are accredited with ISO 9001.

Algo stays abreast of the major changes worldwide in terms of technology and processes. This combines with the ability to understand customers' requirement allows for the development of products that meet the challenges of tomorrow.

Algo has comprehensive range of products to cater Residential, Agriculture, Building services, Industrial & waste water segments. Algo's highly qualified Engineers & technicians assure satisfactory service at all time.

The ability & Impetus of ALGO in product development, Pricing, Promotion, e-commerce strategies will result in sustainable competitive advantages for all stake holders. We at ALGO always strive to focus on current industry trend and meet the next generation pumping requirements.



#### Mission, Vision & Values

To provide technologically integrated and ultramodern fluid management systems and solutions for diversified applications at affordable prices and become one of the pump majors globally.

To ensure that we meet all the standards of safety, efficiency, hygiene and environment protection and contribute significantly in developing systems for energy saving.

Our Values are defined by our dedication to Quality, Principles, & Integrity that lead to customers' satisfaction all time and ultimate success of the company and its stakeholders.



#### Quality Policy

We are determined to offer reliable & Innovative products and services with high standards, Dedicated to understand & meet customers' requirements on time.

We are committed to focus on introducing industry best technologies & Concepts to save energy, protect environment and to give high priority for customers' satisfaction all time.



# CONTENTS

<b>◆ STAINLESS STEEL CENTRIFUGAL PUMPS (CMS SERIES)</b>	
Technical Details	4
Performance Details	5
Dimensional Details	7
<b>◆ SELF - PRIMING JET PUMPS (JS &amp; JB SERIES)</b>	
Technical Details	8
Performance Details	9
Dimensional Details	10
<b>◆ CENTRIFUGAL PUMPS (CM SERIES)</b>	
Technical Details	11
Performance Details	12
Dimensional Details	15
<b>◆ PERIPHERAL PUMPS (AP SERIES)</b>	
Technical Details	16
Performance & Dimensional Details	17
<b>◆ AUTOMATIC PRESSURE BOOSTER SYSTEM (PRESSMAC SERIES)</b>	
	18
<b>◆ ELECTRONIC PRESSURE CONTROL &amp; FLOAT SWITCH</b>	
	19

Stainless Steel

Centrifugal Pumps



Specification	
Power	: 0.37kW - 3.0kW
Speed	: 2900 rpm
Protection	: IP 55 / IP 54
Insulation Class	: 'F' / 'B'
Version	: 1Ph - 230V, 50Hz (PSC)
	Inbuilt with T.O.P.
	3Ph - 380-415V, 50Hz
Direction of Rotation	: Clockwise viewed from driving end
Duty	: S1 (Continuous)
Inlet & Outlet size	: 1" to 3"

Operating Conditions	
Head Max	: 35m
Suction Lift	: 7m (Max)
Max. Liquid Temperature	: +5°C ~ +60°C
Ambient Temperature	: 50°C (Max)

Applications	
Residential	
Irrigation	
Small Farms	
Pressure Boosting Units	
Industrial Water Supply	
Food Processing Industries	
Washing Systems	

Materials of Construction	
Pump Casing	: SS 304
Motor Body	: Aluminium
Impeller	: SS 304
Shaft	: SS 304 + Carbon Steel
Mechanical Seal	: Carbon & Ceramic



Performance Curves

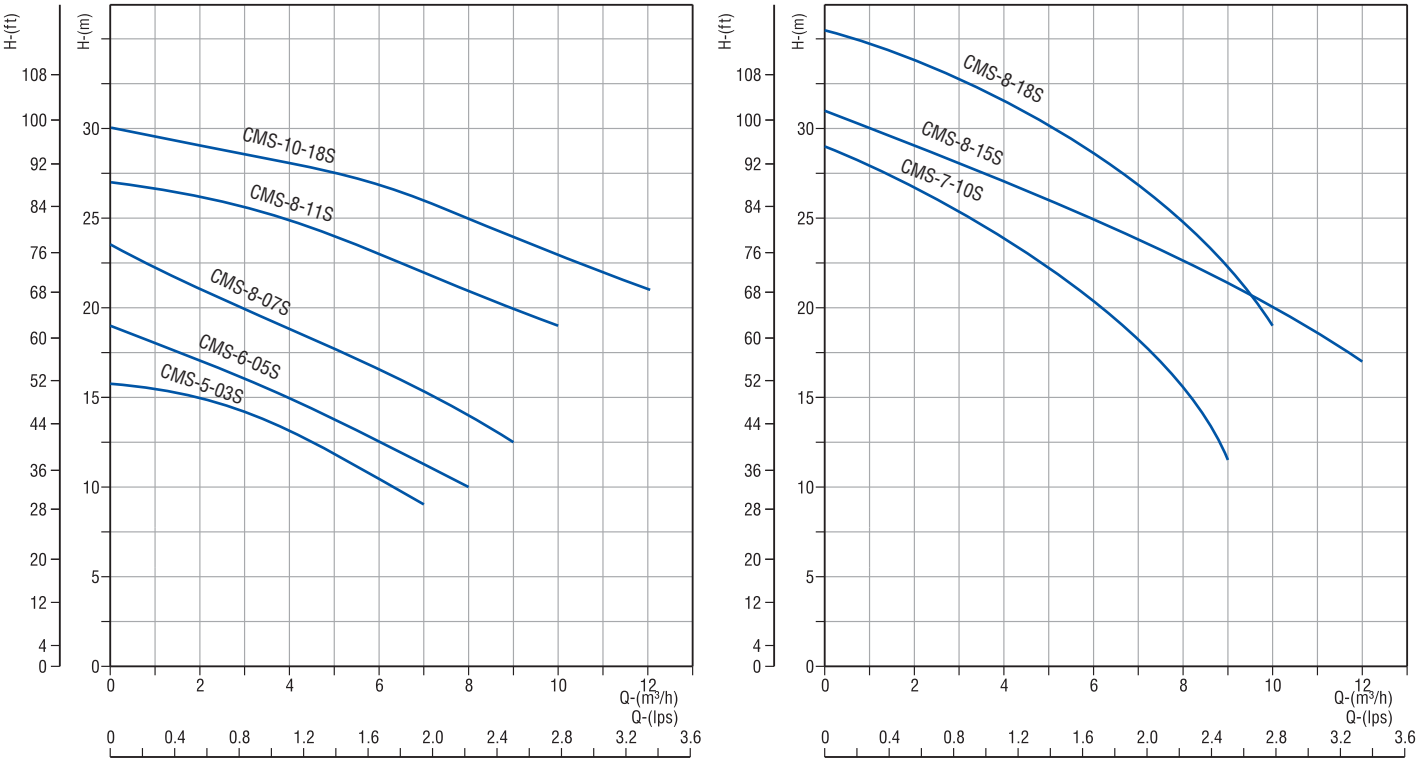

Performance Table

PUMP MODEL	POWER		RATED AMPS		PUMP SIZE IN INCHES (Suc x Del)	Discharge in lps / m³/h											
						0	0.3	0.6	0.8	1.1	1.4	1.6	1.9	2.2	2.5	2.8	3.3
	0	1	2	3		4	5	6	7	8	9	10	12				
	Total Head in Meters																
CMS-5-03S	0.37	0.5	2.4	-	1¼ x 1	16.5	15.5	15	14.5	13	12	10.5	9				
CMS-6-05S	0.55	0.75	3.8	1.4	1¼ x 1	19	18	17	16	15	13.5	12.5	11	10			
CMS-8-07S	0.75	1.0	5.2	1.8	1¼ x 1	23.5	22	21	20	18.5	17.5	16.5	15	14	12.5		
CMS-7-10S	1.0	1.3	6.2	2.4	1¼ x 1	29	28	26.5	25.5	24	22.5	20.5	18.5	15.5	11.5		
CMS-8-11S	1.1	1.5	7	2.6	1¼ x 1	27	26.5	26	25.5	25	24	23	22	21	20	19	
CMS-8-15S	1.5	2.0	9.2	3.5	1¼ x 1	31	30	29	28	27	26	25	24	23	21	20	17
CMS-8-18S	1.8	2.5	13	4.1	1¼ x 1	36.5	35	34	33	32	30	28.5	27	24	22	19	
CMS-10-18S	1.8	2.5	13	4.1	1½ x 1¼	30	29.5	29	28.5	28	27.5	27	26	25	24	23	21

Note: In the Model Name replace the last latter "S" with "T" for 3 Phase Models.

Performance Curves

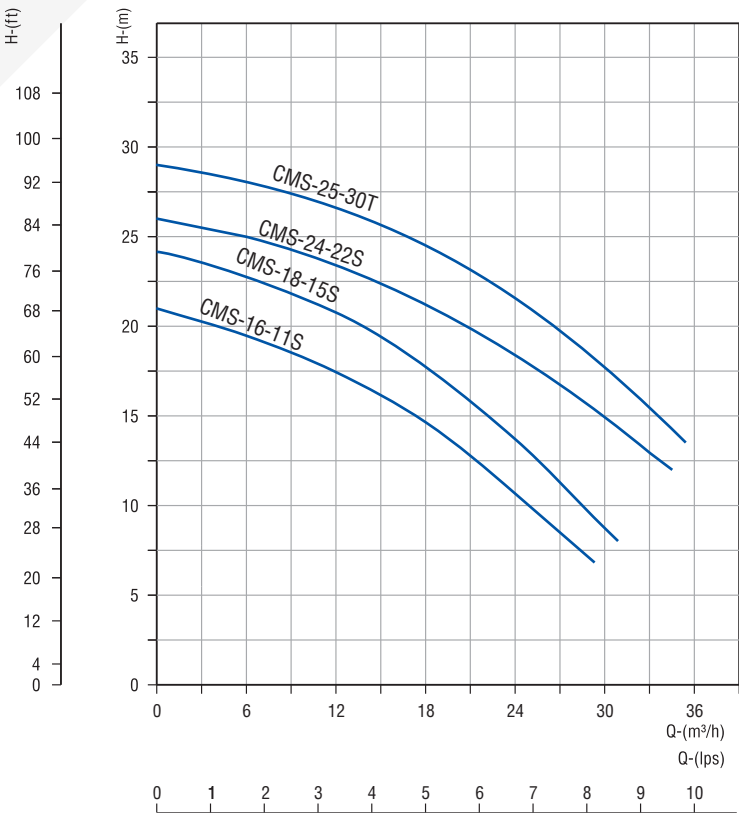

Performance Table

PUMP MODEL	MOTOR POWER		RATED AMPS		NOMINAL PUMP SIZE IN INCHES (Suc x Del)	Discharge in lps / m³/h													
						0	0.8	1.7	2.5	3.3	4.2	5.0	5.8	6.7	7.5	8.3	9.2	10	
	0	3	6	9		12	15	18	21	24	27	30	33	36					
	Total Head in Meters																		
CMS-16-11S	1.1	1.5	7	2.6	2 x 2	21	20	19	18.5	17.5	16.5	14.5	13	11	8.5	7 (29m³/h)			
CMS-18-15S	1.5	2.0	9.2	3.5	2 x 2	24	23.5	23	22	21	19	17.5	16	13.5	11	8.5	8 (31m³/h)		
CMS-24-22S	2.2	3.0	14	4.9	2 x 2	26	25.5	25	24.5	23.5	22.5	21.5	20	18.5	17	15	13	12 (34m³/h)	
CMS-25-30T	3.0	4.0	-	6.3	2 x 2	29	28.5	28	27.5	26.5	25.5	24.5	23	22	20	17.5	15.5	13.5 (35m³/h)	

Note: In the Model Name replace the last latter “S” with “T” for 3 Phase Models.

## Dimensional Drawings

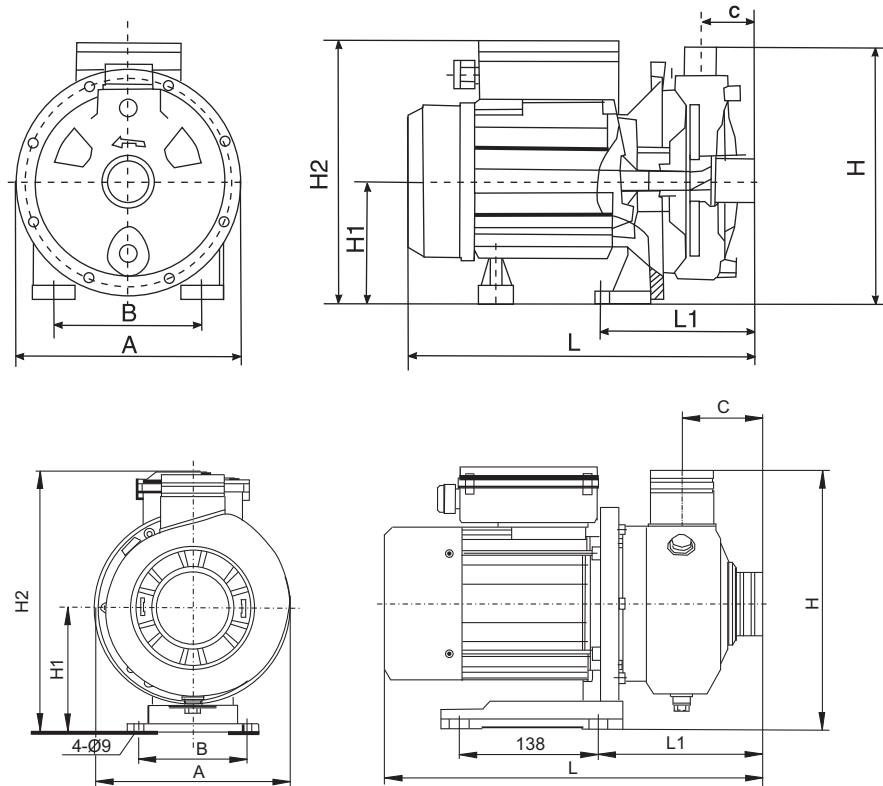

**CMS-5-03S**      **CMS-8-11S**  
**CMS-6-05S**      **CMS-8-15S**  
**CMS-8-07S**      **CMS-8-18S**  
**CMS-7-10S**      **CMS-10-18S**

**CMS-16-11S**  
**CMS-18-15S**  
**CMS-24-22S**  
**CMS-25-30T**

## Dimensional Data

PUMP MODEL	POWER		A	B	C	H	H1	H2	L	L1	Weight in kg.
	kW	HP									
CMS-5-03S	0.37	0.5	213	120	44	212	108	221	315	135	11.5
CMS-6-05S	0.55	0.75	213	120	44	212	108	221	315	135	12
CMS-8-07S	0.75	1	213	120	44	212	108	221	315	135	13
CMS-7-10S	1	1.3	213	140	47	222	110	242	313	138	15.5
CMS-8-11S	1.1	1.5	240	120	44	257	120	257	378	144	23
CMS-8-15S	1.5	2	240	150	49	257	120	257	378	144	24
CMS-8-18S	1.8	2.5	234	150	49	240	120	251	337	140	22
CMS-10-18S	1.8	2.5	231	140	47	222	110	255	366	138	21.5
CMS-16-11S	1.1	1.5	193	108	82	258	125	265	378	165	16.5
CMS-18-15S	1.5	2	193	108	82	258	125	265	378	165	18
CMS-24-22S	2.2	3	193	108	82	258	125	242	415	165	22
CMS-25-30T	3	4	193	108	82	258	125	242	432	165	23

\* All Dimensions are in mm.

Self Priming  
JET Pumps



Specification	
Power	: JS : 0.37 kW - 1.1 kW JB : 0.37 kW - 1.1 kW
Speed	: 2900 rpm
Protection	: IP 54 / IP 44
Insulation Class	: "B"
Versions	: 1Ph - 230V, 50Hz (PSC) Inbuilt with T.O.P 3Ph - 380-415V, 50Hz
Direction of Rotation	: Clockwise viewed from driving end
Duty	: S1 (Continuous)
Suction and Delivery Size	: 1" x 1", 1¼" x 1" (BSP)

Operating Conditions	
Head Max	: 48.5m
Suction Lift	: 7m (Max)
Max. Liquid Temperature	: +5°C ~ +60°C
Ambient Temperature	: 50°C (Max)

Applications
Residential
Irrigation
Small Farms
Pressure Boosting Units
Industrial Water Supply
Food Processing Industries
Washing Systems

Materials of Construction		
	JS	JB
Pump Casing	: SS 304	Cast Iron
Motor Frame	: Aluminium	Aluminium
Impeller	: SS 304	Brass
Shaft	: SS 304	SS 304
Mechanical Seal	: Carbon & Ceramic	Carbon & Ceramic



## Performance Curves

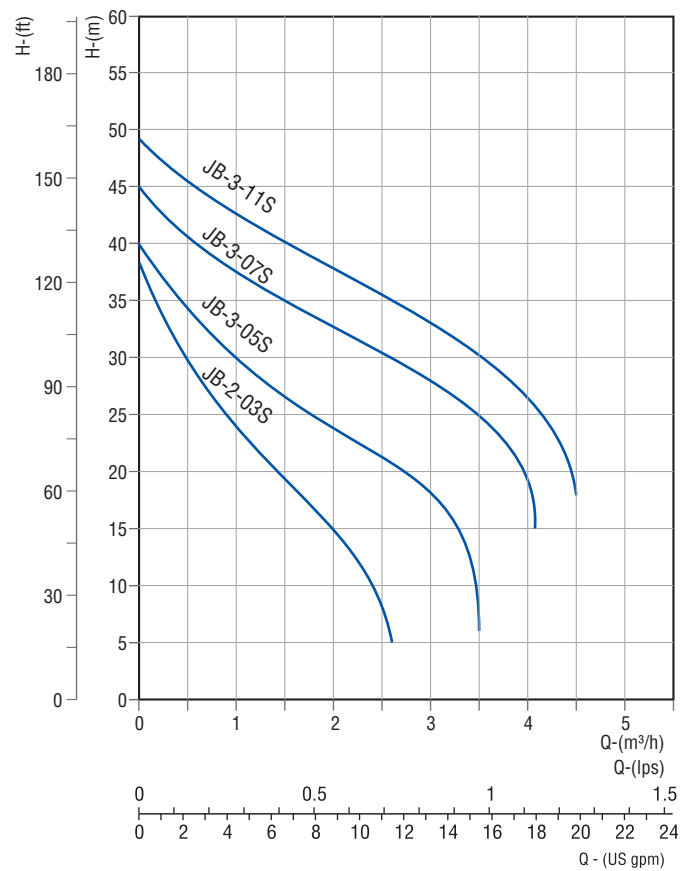
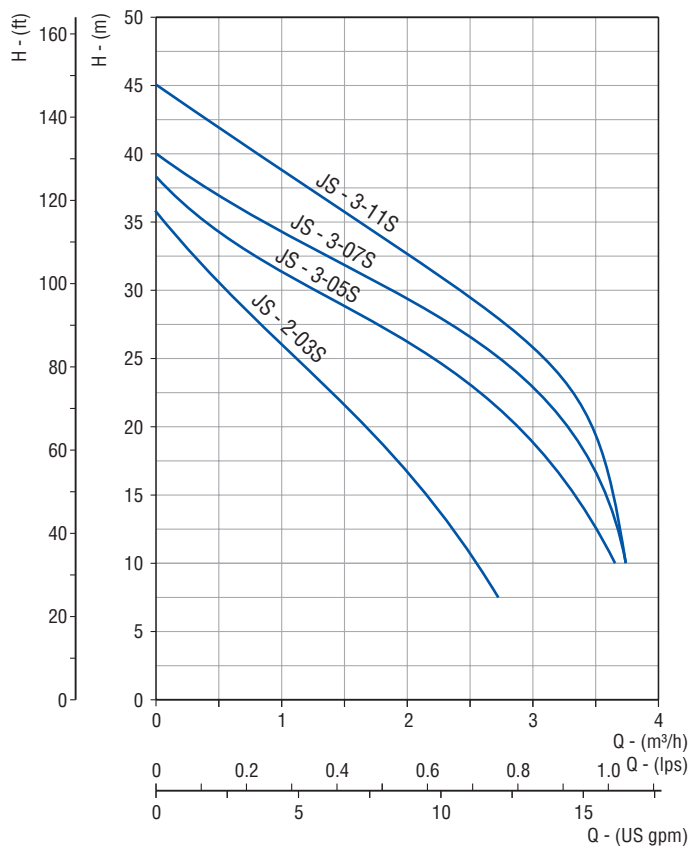

## Performance Table

PUMP MODEL	POWER		RATED AMPS		PUMP SIZE IN INCHES (Suc x Del)	Discharge in lps / m³/h							
						0	0.1	0.3	0.4	0.6	0.7	0.8	1.0
						0	0.5	1	1.5	2	2.5	3	3.5
						Total Head in Meters							
JS-2-03S	0.37	0.5	3.1	0.93	1 x 1	36	31	26.5	21.5	17	11	7 (2.75m³/h)	-
JS-3-05S	0.55	0.75	4.3	1.49	1 x 1	38	34	31.5	28.5	26.5	23	18.5	10 (3.7m³/h)
JS-3-07S	0.75	1.0	4.5	1.63	1 x 1	40	37	34	32	29	26.5	23	17
JS-3-11S	1.1	1.5	5.3	2.65	1 x 1	45	42	38.5	36	32.5	29.5	26.5	19.5

PUMP MODEL	POWER		RATED AMPS		PUMP SIZE IN INCHES (Suc x Del)	Discharge in lps / m³/h					
						0	0.3	0.6	0.8	1.1	1.4
						0	1	2	3	4	5
						Total Head in Meters					
JB-2-03S	0.37	0.5	3.1	0.9	1" x 1"	38	24	15	5 (2.6m³/h)		
JB-3-05S	0.55	0.75	4.6	1	1" x 1"	40	30	24	18	10 (3.5m³/h)	
JB-3-07S	0.75	1	5	1.6	1" x 1"	45	37	33	28	20	
JB-3-11S	1.1	1.5	7.5	2	1¼" x 1"	49	42	38	33	27	20 (4.4m³/h)

**Note:** In the Model Name replace the last letter "S" with "T" for 3 Phase Models.

On request pumps can also be supplied with automatic pressure switch. Prefix letter "AF" with above model name for pumps including pressure switch.

Dimensional Data

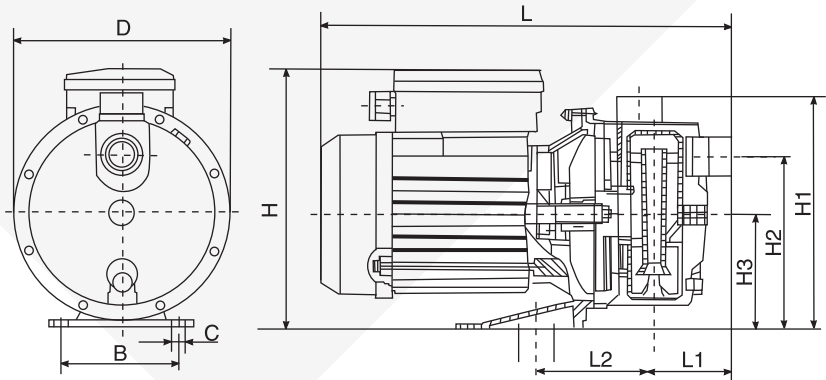

PUMP MODEL	POWER		B	C	D	H	H1	H2	H3	L	Weight in kg.
	kW	HP									
JS-2-03S	0.37	0.5	160	8	196	218	206	161	105	380	9
JS-3-05S	0.55	0.75	160	8	196	218	206	161	105	380	10
JS-3-07S	0.75	1.0	160	8	196	218	206	161	105	380	11
JS-3-11S	1.1	1.5	160	8	196	218	206	161	105	380	11.5

\* All Dimensions are in mm.

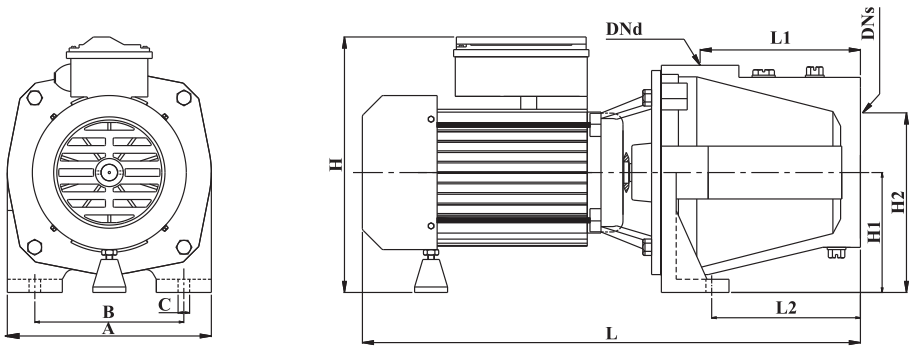

**JB SERIES**

PUMP MODEL	POWER		Dns	DNd	L	L1	L2	A	B	C	H1	H2	H	Weight in kg.
	kW	HP												
JB-2-03S	0.55	0.75	1"	1"	440	140	235	181	140	10	100	158	213	14
JB-3-05S	0.75	1	1"	1"	395	112.5	133	182	142	10	97	152.5	210	14.5
JB-3-07S	1.1	1.5	1 1/4"	1"	395	112.5	133	182	142	10	97	152.5	210	15.5
JB-3-11S	1.5	2	1 1/4"	1"	395	112.5	133	182	142	10	97	152.5	210	16.5

\* All Dimensions are in mm.

Centrifugal  
Monoblock Pumps



Specification	
Power	: 0.37 - 2.2 kW
Speed	: 2900 rpm.
Protection	: IP 44 / IP 54
Insulation Class	: 'B' / 'F'
Versions	: 1 Ph - 230V, 50Hz (PSC)
	Inbuilt with T.O.P
	3 Ph - 380-415V, 50Hz
Direction of Rotation	: Clockwise viewed from driving end
Duty	: S1 (Continuous).
Inlet & Outlet size	: 1" to 3"

Operating Conditions	
Head Max	: 51 m
Suction Lift	: 7 m (Max)
Max. Liquid Temperature	: 40°C
Ambient Temperature	: 55°C (Max)

Applications	
Residential	
Irrigation	
Farms	
Industrial Water Supply	
General Water Supply	
Drip & Sprinkler Systems	
Water treatment plants	

Materials of Construction	
Pump Casing	: Cast Iron
Motor Body	: Aluminium
Impeller	: Brass / SS
Shaft	: SS 304 + Carbon Steel
Mechanical Seal	: Carbon & Ceramic

Performance Curves

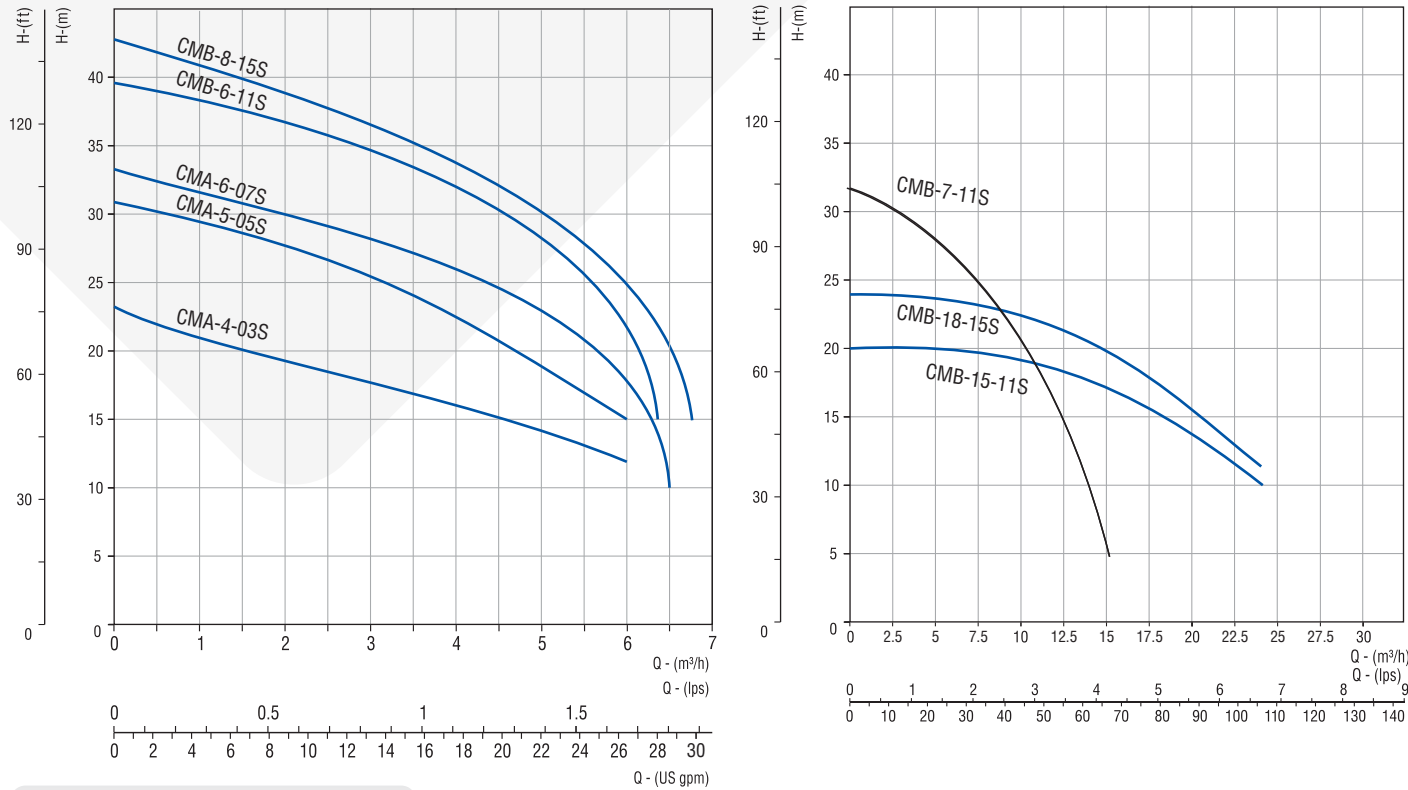

Performance Table

PUMP MODEL	MOTOR POWER		RATED AMPS		NOMINAL PUMP SIZE IN INCHES (Suc x Del)	Discharge in lps / m³/h							
						0	0.3	0.6	0.8	1.1	1.4	1.7	1.9
						0	1	2	3	4	5	6	7
						Total Head in Meters							
CMA-4-03S	0.37	0.5	4.6	1.6	1 x 1	23	21	18.5	17.5	16	14	12	
CMA-5-05S	0.55	0.75	5.5	2	1 x 1	31	29	28	25	22.5	20	15	
CMA-6-07S	0.75	1.0	6.4	2.5	1 x 1	33	32	30	28	25.5	23	18	10 (6.2m³/h)
CMB-6-11S	1.1	1.5	8.85	2.65	1 x 1	39	38	37	34.5	32	28	22	15 (6.3m³/h)
CMB-8-15S	1.5	2.0	9.38	3.51	1 x 1	43	42	38.5	37	33	30	25	15 (6.7m³/h)

PUMP MODEL	POWER		RATED AMPS		PUMP SIZE IN INCHES (Suc x Del)	Discharge in lps / m³/h							
						0	1.4	2.1	2.8	3.5	4.2	5.6	6.7
						0	5	7.5	10	12.5	15	20	24
						Total Head in Meters							
CMB-7-11S	1.1	1.5	7.5	2.8	1¼ x 1	32	28	25	21	15	5		
CMB-15-11S	1.1	1.5	7.5	2.8	2 x 2	20	19.5	19.5	19	18.5	17.5	13	10
CMB-18-15S	1.5	2	11	4	2 x 2	24	22	23	22.5	21	20	15	11.5

**Note:** In the Model Name replace the last latter “S” with “T” for 3 Phase Models.  
On request pumps can also be supplied with automatic pressure switch. Prefix letter “AF” with above model name for pumps including pressure switch.

Performance Curves

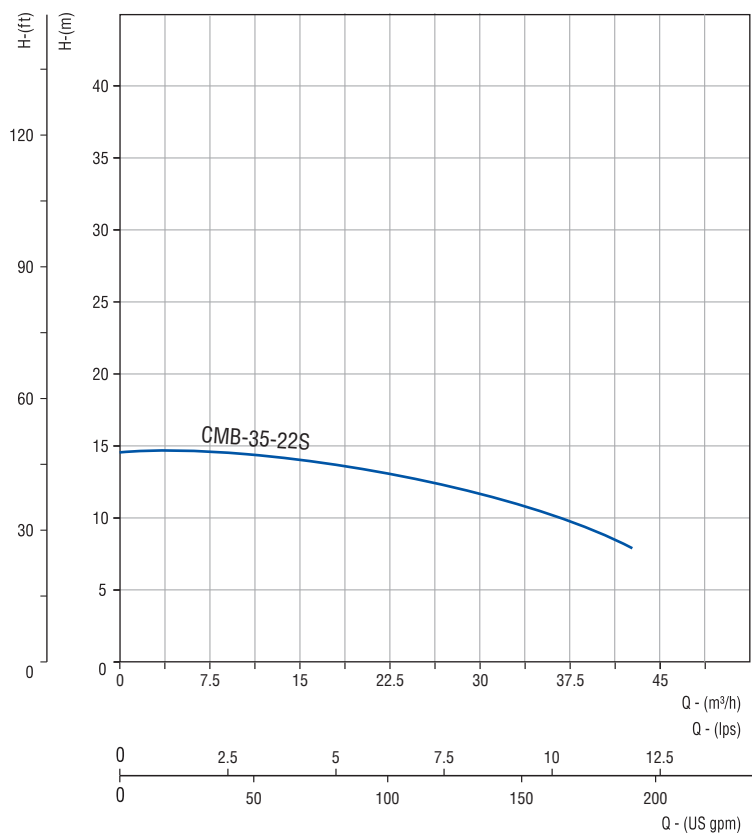

Performance Table

PUMP MODEL	POWER		RATED AMPS		PUMP SIZE IN INCHES (Suc x Del)	Discharge in lps / m³/h								
						0	2.8	4.17	5.56	6.94	8.33	9.72	11.11	12.5
						0	10	15	20	25	30	35	40	45
	Total Head in Meters													
CMB-35-22S	2.2	3.0	14	5.5	3 x 3	14.5	14	13.5	13	12.5	12	10.5	9	8 (42m³/h)

**Note:** In the Model Name replace the last letter “S” with “T” for 3 Phase Models.



Performance Curves

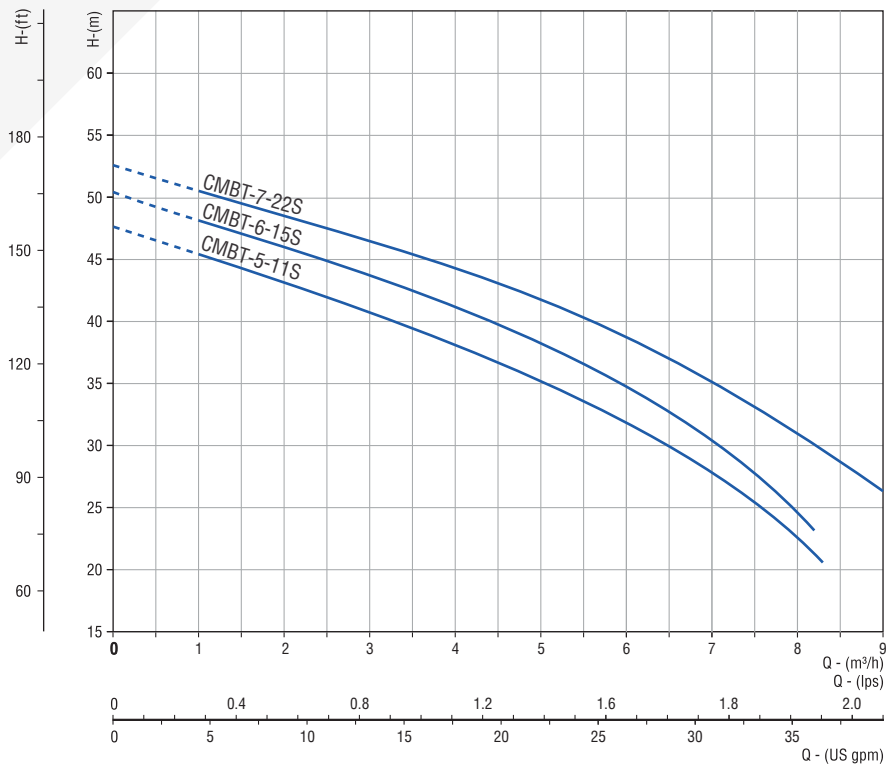

Performance Table

PUMP MODEL	POWER		RATED AMPS		PUMP SIZE IN INCHES (Suc x Del)	Discharge in lps / m³/h								
						0	0.6	0.8	1.1	1.4	1.7	1.9	2.2	2.5
	kW	HP	1Ph 230V	3Ph 380V		0	2	3	4	5	6	7	8	9
						Total Head in Meters								
CMBT-5-11S	1.1	1.5	8.32	2.65	1¼ x 1	47.5	43	41	38	35.5	32	27.5	22	
CMBT-6-15S	1.5	2	10.13	4.2	1¼ x 1	50.5	47	43	41	38	35	30	25	
CMBT-7-22S	2.2	3	13.43	5.2	1¼ x 1	52.5	48.5	46	44	42	38.5	35	31	26

Note: In the Model Name replace the last latter “S” with “T” for 3 Phase Models.

Dimensional Drawings

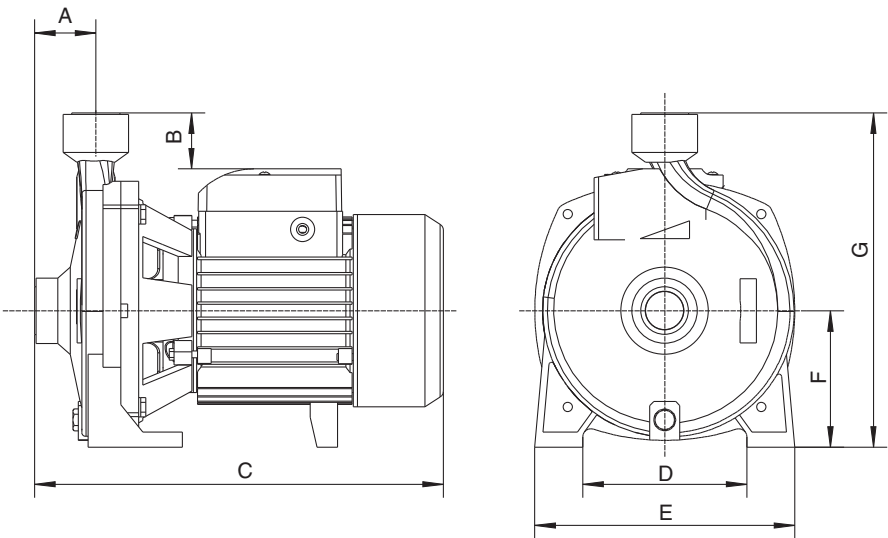

Dimensional Data

PUMP MODEL	POWER		A	B	C	D	E	F	G	Weight in kg.
	kW	HP								
CMA-4-03S	0.37	0.5	46	20	285	113	150	84	207	9.5
CMA-5-05S	0.55	0.75	48	27	320	140	182	100	240	15
CMA-6-07S	0.75	1.0	48	27	320	140	182	100	240	15.5
CMB-7-11S	1.1	1.5	44	46	352	180	220	115	284	21.5
CMB-6-11S	1.1	1.5	50	25	302	140	200	105	255	19
CMB-8-15S	1.5	2.0	44	46	363	180	220	115	284	22.5
CMB-15-11S	1.1	1.5	60	20	375	160	207	112	159	22
CMB-18-15S	1.5	2.0	57	44	385	135	182	107	218	23
CMB-35-22S	2.2	3.0	68	65	435	190	240	120	312	30
CMBT-5-11S	1.1	1.5	81	20	387	170	210	117	264	21.5
CMBT-6-15S	1.5	2.0	81	20	387	170	210	117	264	22.5
CMBT-7-22S	2.2	3.0	90	38	450	190	240	135	300	30.5

\* All Dimensions are in mm.

# Peripheral Pumps



Specification	
Power	: 0.37 & 0.75 kW
Speed	: 2900 rpm
Type	: 1 Ph 230V, 50Hz, (PSC) Inbuilt with T.O.P.
Duty	: S1 (Continuous)
Direction of Rotation	: Clockwise viewed from driving end
Protection	: IP 54
Insulation Class	: 'B'
Inlet & Outlet size	: 1" x 1"

Applications	
Residential	
Gardens	
Washing Systems	
Pressure Boosting Unit	
Civil Applications	

Operating Conditions	
Suction Lift	: 8m
Flow Rate	: 2.2m³/h
Maximum Head Max	: 70m
Max. Operating Pressure	: 7 bar.
Max. Liquid Temperature	: 50°C
Ambient Temperature	: 40°C (Max)

Materials of Construction	
Casing	: Cast Iron with SS insert
Motor Body	: Aluminium Alloy
Impeller	: Forged Brass
Pump Bracket	: Cast Iron
Shaft	: SS 410
Mechanical Seal	: Carbon & Ceramic
O Ring	: NBR

Performance Curves

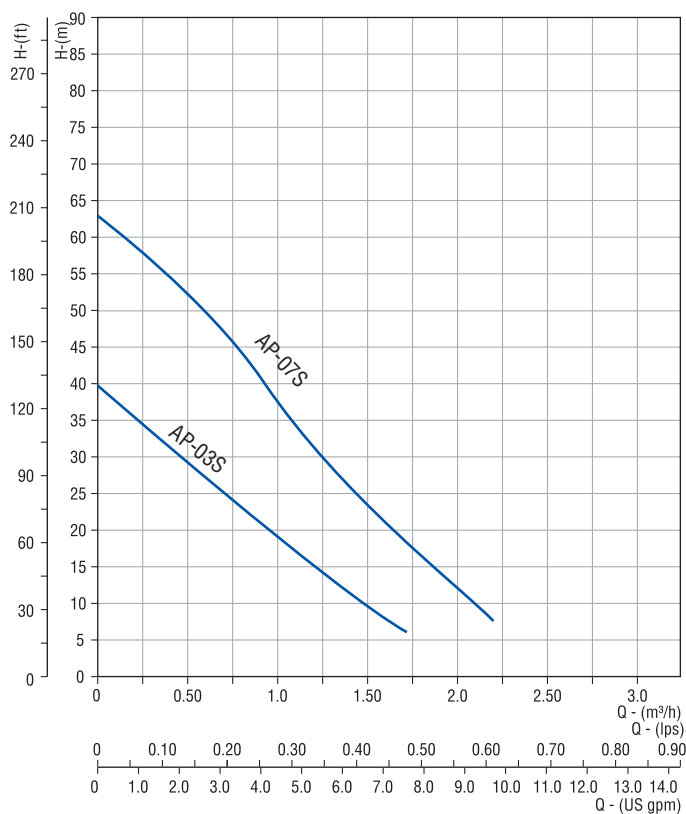

Dimensional Drawing

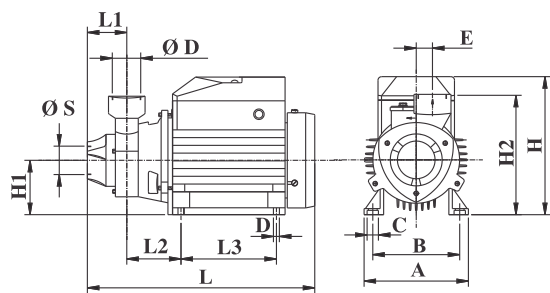

Performance Table

PUMP MODEL	POWER		AMPS 1Ph-230V	PUMP SIZE IN INCHES (Suc x Del)	SUCTION LIFT IN m	Discharge in lps / m³/h							
	kW	HP				lps	0	0.1	0.2	0.3	0.4	0.5	0.6
						m³/h	0	0.4	0.7	1.1	1.4	1.8	2.2
AP-03S	0.37	0.5	2.5	1 x 1	8	Total head in meters	40	32	26	18	11	6 (1.6m³/h)	
AP-07S	0.75	1.0	5.2	1 x 1	8		63	55	48.5	34	25	16	7

Dimension Details

PUMP MODEL	ØS	ØD	L2	L3	L	A	B	D	C	E	H	H2	H1	L1	Weight in kg.
AP-03S	1"	1"	61	80	265	118	100	10	10	20	151	138	63	45	5.3
AP-07S	1"	1"	66	90	305	136	112	10	10	21	181	150	73	50	10

Note: On request pumps can also be supplied with automatic pressure switch. Prefix letter "AF" with above model name for pumps including pressure switch. \* All Dimensions are in mm.

Automatic Pressure Booster System

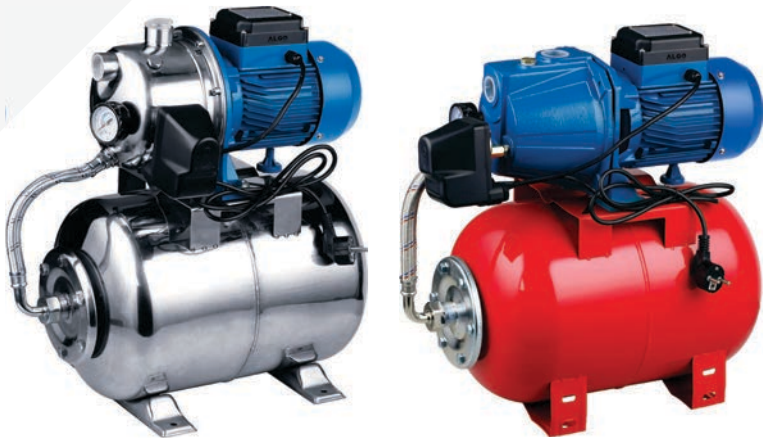

Performance Details

MODEL	TANK CAPACITY in lts	POWER		Inlet & Outlet Size in Inches	Head (Suc) in m	l/s m³/h	0.42	0.61	0.66	Pressure switch setting (bar)		Pressure level in pressure tank (PSI)
		kW	HP				1.5	2.2	2.4	ON	OFF	
24PMJS-3-05S	24	0.55	0.75	1 x 1	7	Head in meters	27	25	23	1	2.5	15 - 18
24PMJS-3-07S	24	0.75	1.0	1 x 1	7		31	28	26	2.1	3.5	15 - 18
24PMJB-3-05S	24	0.55	0.75	1 x 1	7		26	24	20	1.4	2.8	15 - 18
24PMJB-3-07S	24	0.75	1.0	1 x 1	7		36	32	30	2.1	3.5	15 - 18

The above models can be supplied with 60 ltrs tank also.

Dimensional Details

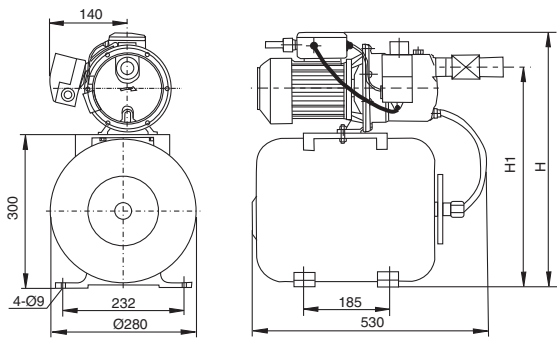

MODEL	Dimensions in mm		Weight in kg
	H	H1	
24PMJS-3-05S	428	495	14.5
24PMJS-3-07S	452	540	15.5

\* All Dimensions are in mm.



## Electronic Pressure Controls

Electronic pressure switches are used to automatically start and stop the pumps based on the pressure level in the pipe line. It switches ON the pump whenever there is pressure drop in the pipe line & switches OFF the pump automatically when all the taps are closed. These switches are inbuilt with non return valve & also prevent the pump from dry running.



EP-15V  
/ EP-22V



EP-22AV



EP-15H  
/ EP-22H

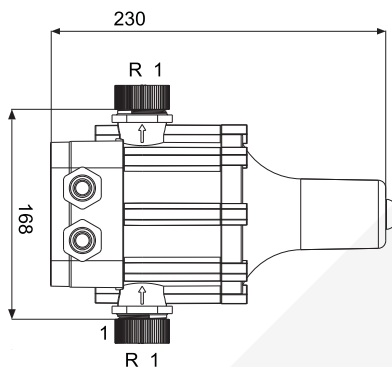
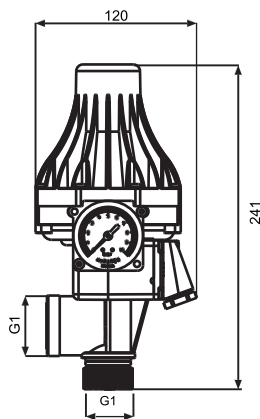

### Specification

- Rated Voltage: 220-240V/110-120V
- Frequency: 50 / 60 Hz
- Max Current / Max Power: 10A/1.1 KW / 16A/1.5KW
- Starting Pressure Setting: 1.2 bar, 1.5bar, 2.2bar
- Max Working Pressure: 10Bar
- Connection Thread: R1"
- Protection: IP65
- Max Working Temperature: 50° C

### Features

- Automatically starts and stops the pump
- Protection against dry running
- Built-in NRV prevents from back flow of water
- Ensure adequate pressure in the pipe line
- Sets free from operating the pump manually
- Built in reset button.
- Adjustable cut-in pressure setting (for Vertical type)

## Float Switch

### Specification

• Rated Voltage	220/230/240V
• Rated Current	8A / 10A
• Frequency	50 / 60Hz
• Protection	IP67
• Working temperature	55°C



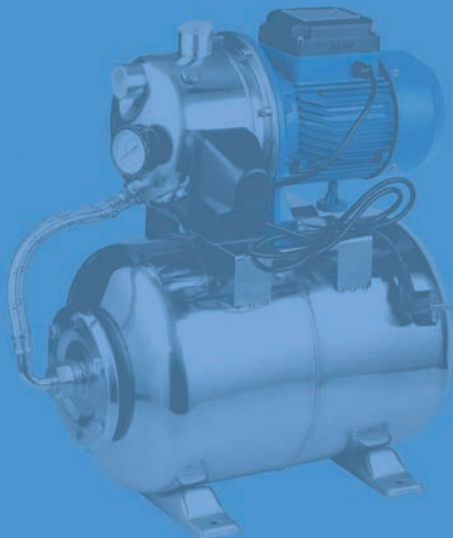

Registered Office

**ALGO FLUID SYSTEMS PRIVATE LIMITED**

Plot No: 2403/1, G.I.D.C. Estate, Ahmedabad Mehsana Highway,  
Chhatral, Tal. Kalol, Dist. Gandhinagar - 382729, Gujarat. India.  
Tel.: +91-2764-234240 / 8098770708 | E-mail: sales@algopumps.com

Associate Companies

**ALGO HYDRO TECH**

No: 18, Siva Jothi Colony, Goldwins, Civil Aerodrome Post,  
Coimbatore - 641014, Tamilnadu. India.  
Tel.: +91 9976170074 | E-mail: salescbe@algopumps.com

CITB Plot No. 20, 3rd Cross, Opp. Akshay Park, Gokul Road,  
Hubballi, Dist. Dharwad - 580030, Karnataka. India.  
Ph.: +91 7411213111 | E-mail: ramesh@algopumps.com